

Marcelino

Rua José de Carvalho

144  
147

PREFEITURA MUNICIPAL DE JOÃO LISBOA

SERVIÇO:		RECAPEAMENTO DE VIAS URBANAS NO MUNICIPIO DE JOÃO LISBOA	
TÍTULO:		PROJETO GEOMETRICO	DES. Nº: 01/08
TRECHO:		RESP. TÉCNICO: LA PROJETO E CONSULTORIA LTDA	
SUB-TRECHO:		Demostenes Sousa Lima	
PROJETISTA:	DESENHISTA:	ESCALA: 1 : 500	DATA: JULHO/2008
		Engenheiro Civil CREA 7350/D-MA	

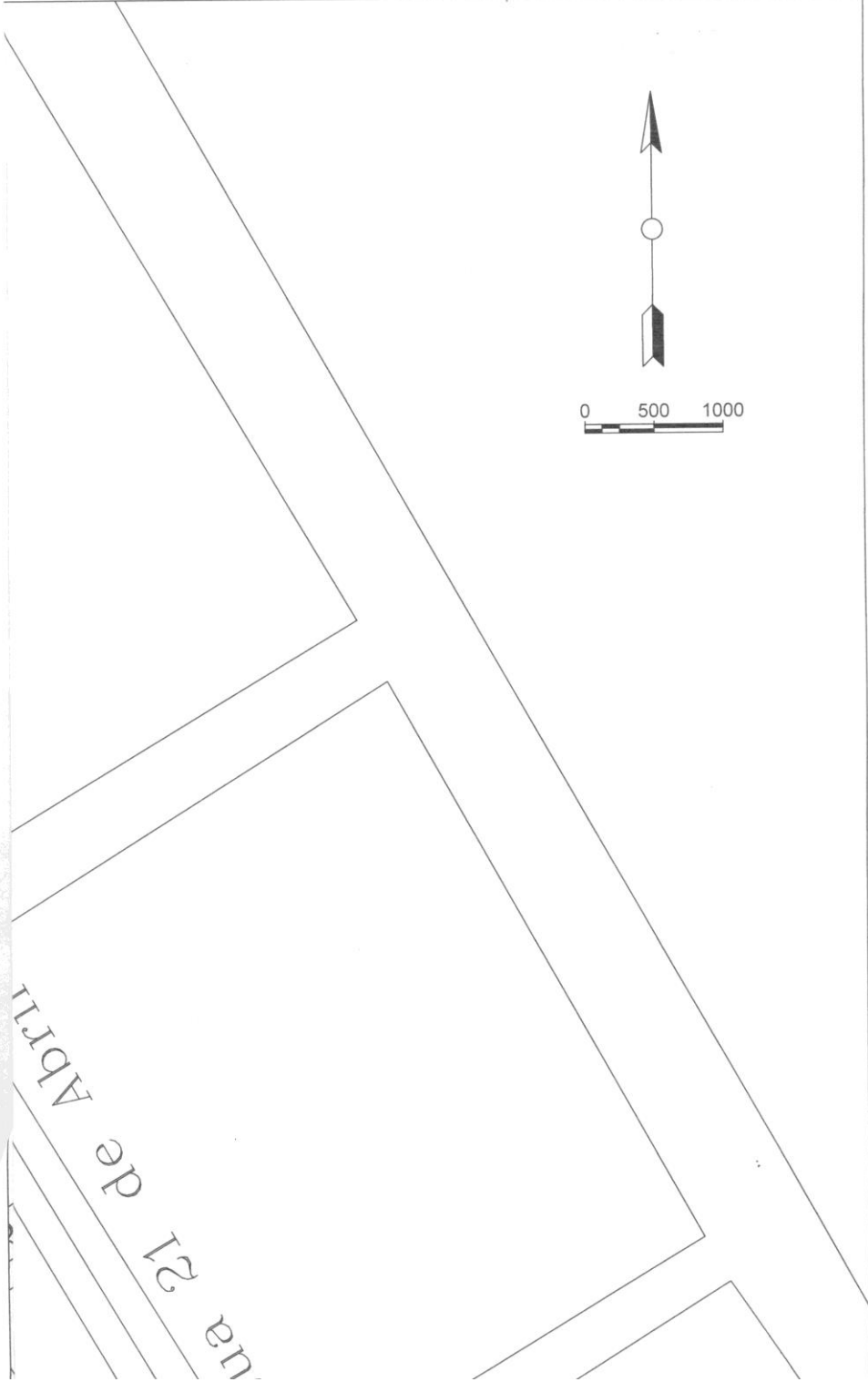

0 500 1000

na 21 de Abril

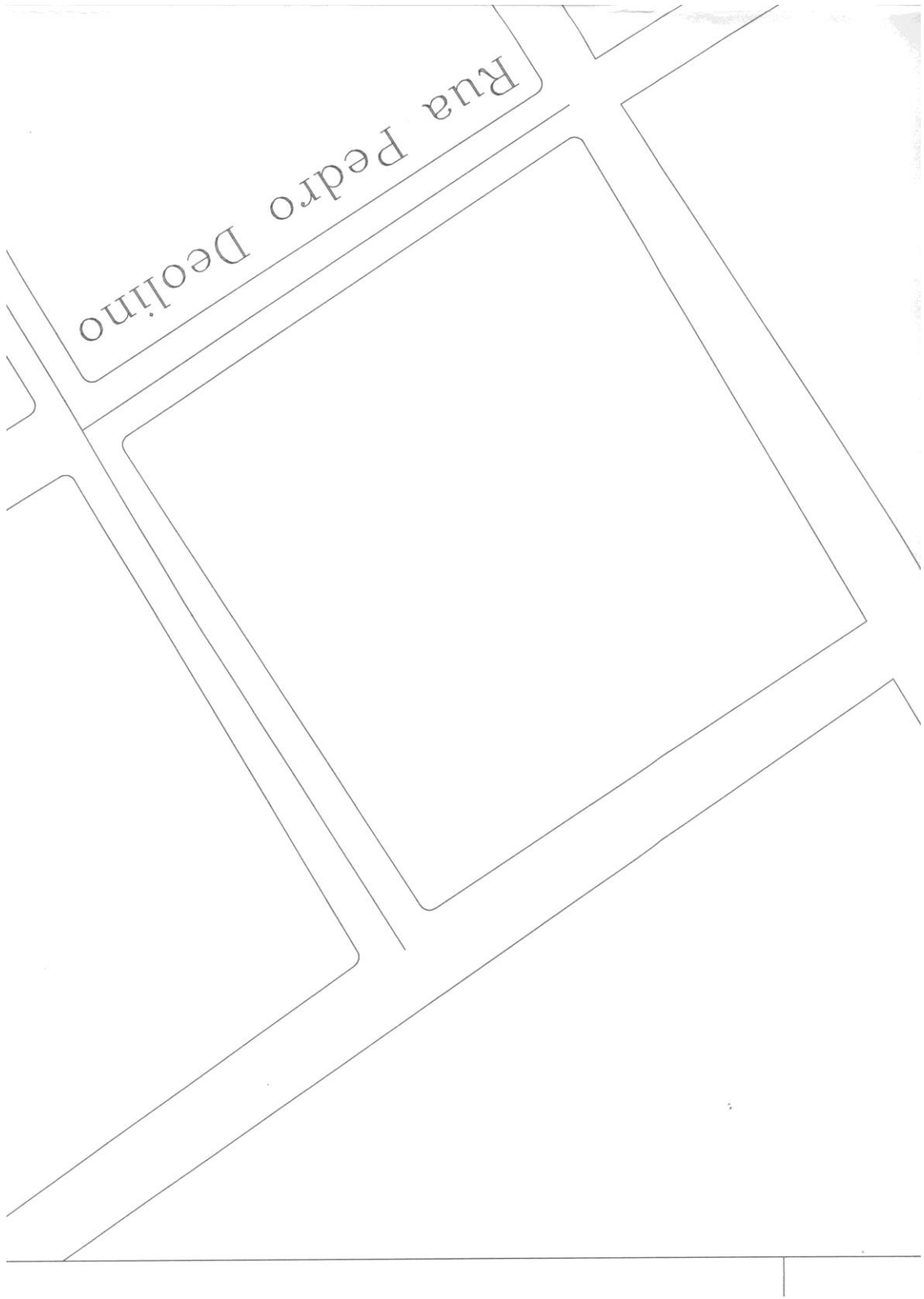







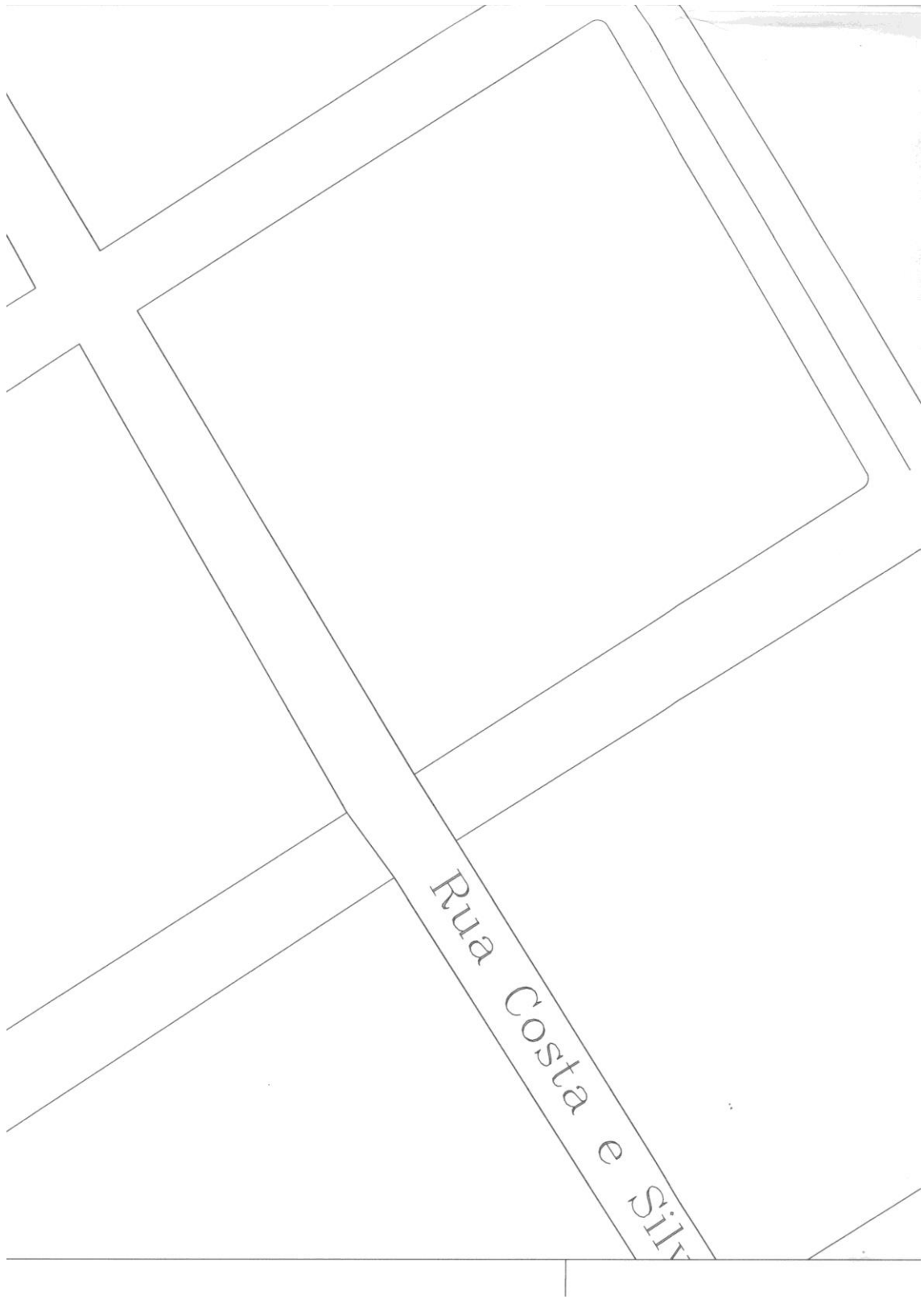





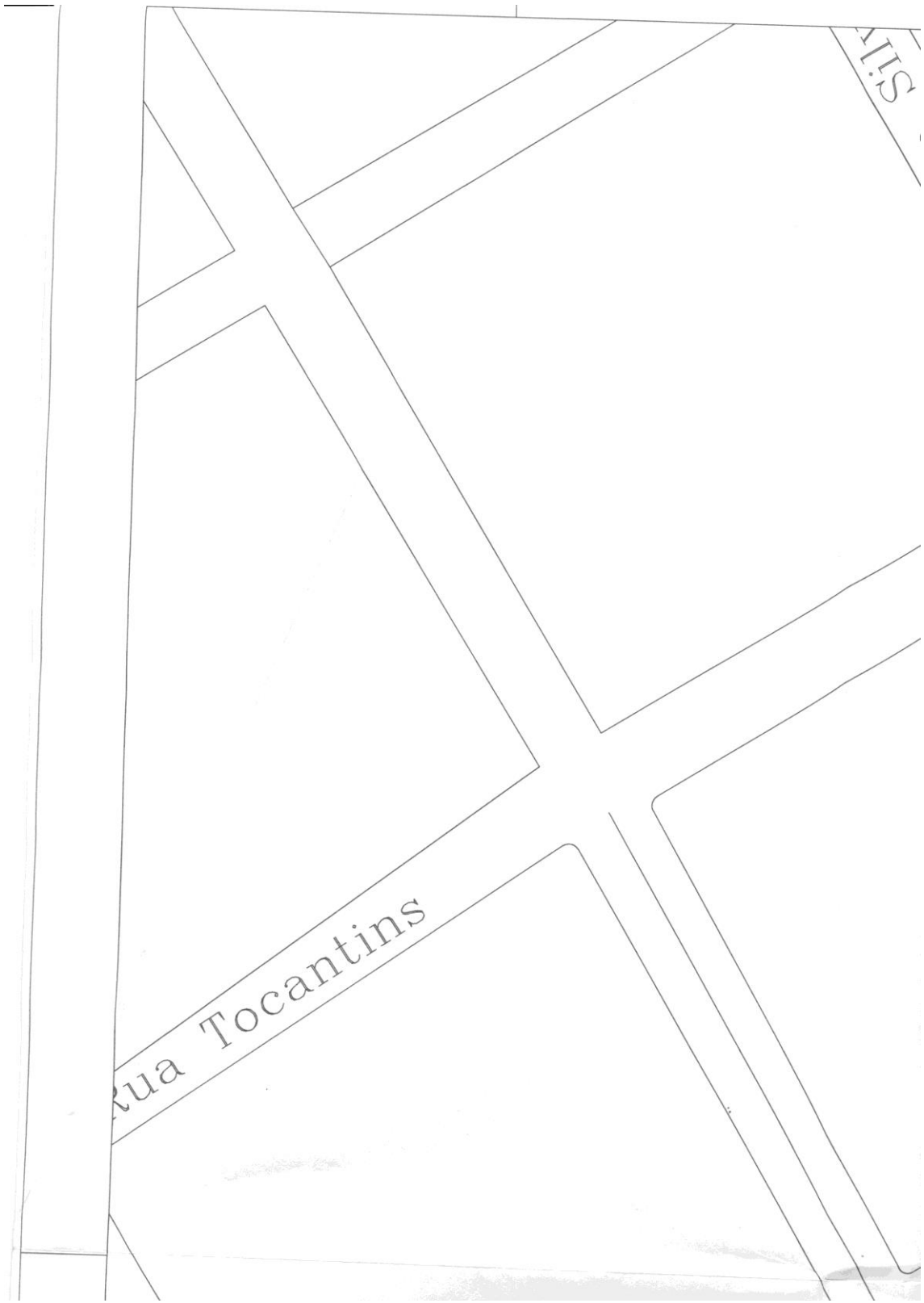

Rua Nestor Milhomem

